

# Installing the Dual Beer & Cocktail Tap Kit

## Model:

KITSBCCKT2

The tap kit is pre-assembled for easy installation. Users only need to connect the D-Coupler to the beer keg and the ball lock fittings to the cocktail keg.

### Included:

- Tower (1)
- Handles (2)
- Screws (4)
- Empty CO<sub>2</sub> Tank (1)
- Empty N<sub>2</sub> Tank (1)
- D-Coupler (1)
- Elbow Coupler Connection (1)
- Outlet Ball Lock Fitting (1)
- Inlet Ball Lock Fitting (1)

**Note:** Your CO<sub>2</sub> and N<sub>2</sub> tanks are shipped empty to avoid any possible accidents during transportation. **When you purchase the first keg of beer, have your beer distributor fill the gas tanks. Before installation, please read and understand all gas tank handling procedures.**

### Note:

- These taps should not be used for milk.
- When replacing your keg, first turn off the safety switch on the CO<sub>2</sub> & N<sub>2</sub> regulator valve and remove the coupler to take out the keg.
- When replacing the CO<sub>2</sub> & N<sub>2</sub> gas tanks, remember to turn off the main switch of both gas tanks and the safety switch on the regulator valves. Afterward, use a wrench to loosen the hexagonal nut port connecting the regulator valve with the gas tanks. Then, use a wrench to remove the fixed bolt securing the gas tank, and carefully remove the tank.
- During the installation process, be sure that all parts are connected tightly and that there are no gas leaks.
- When connecting the hose to the connection port, you can dip the ends into warm water to make the connection easier.
- If the high-pressure compressed gas in the CO<sub>2</sub> & N<sub>2</sub> gas tanks are not handled properly, it could be dangerous if not handled properly.
- Make a note of the D.O.T. testing date on the tank's neck before installation. If it is more than 5 years old, do not use the product. Return it to the gas supplier.
- Keep gas tanks away from heat sources. Unused cylinders should be placed upright in a cool, ventilated place (preferably at 70°F).

## Assembling the D-Coupler for the Beer Keg:

The D-coupler is compatible with a single 1/6 barrel keg. Each 1/6 barrel keg holds approximately 5 gallons.

1. Attach the tower to your unit using the screws provided.
2. Hand-tighten the **elbow coupler connection** to the liquid outlet (top) of the **D-coupler**.
3. Connect the beer line (from the tower) to the elbow coupler connection.
  - Use the beer line with the CO<sub>2</sub> tank
4. Connect the **gas regulator** to its corresponding gas tank (Refer to "Installing the CO<sub>2</sub> Regulator" on page 2):
  - **CO<sub>2</sub> regulator** to the **CO<sub>2</sub> tank**
  - **N<sub>2</sub> regulator** to the **N<sub>2</sub> tank**
5. Attach the **CO<sub>2</sub> regulator gas line** for beer from the regulator to the **gas inlet** on the D-coupler.
6. Attach the D-coupler to the beer keg (Refer to "Attaching the D-Coupler" on page 2)
7. Place the CO<sub>2</sub> / N<sub>2</sub> tanks inside the unit.
8. Lift the keg by the handles and gently place them inside the unit.
9. Arrange the tubing neatly behind the kegs to ensure the door can close properly.
10. Screw the handle(s) onto the tower tap(s).

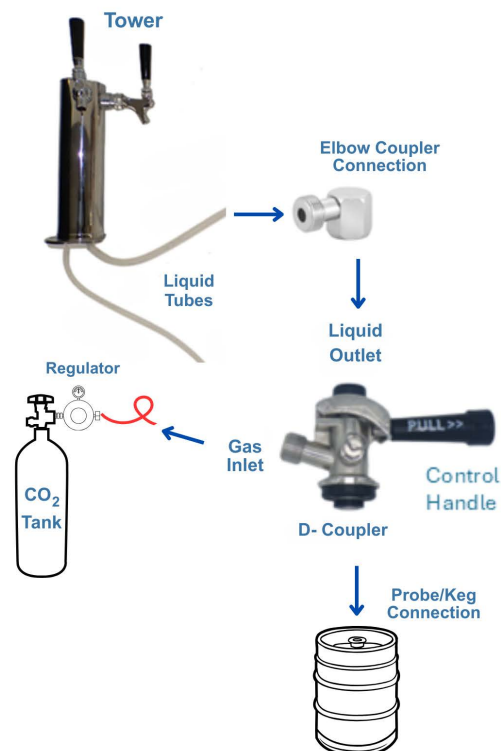

### Installing the CO<sub>2</sub> Regulator to the CO<sub>2</sub> Tank:

(for beer)

1. Ensure the tower dispenser is closed.
2. Position the D-coupler handle in the **upward** position to indicate that the keg is **untapped** (See Figure 1).
3. Ensure the CO<sub>2</sub> tank is full (Gas tanks are shipped empty).
4. Screw the **CO<sub>2</sub> regulator** on to the **CO<sub>2</sub> tank valve**. Use an adjustable wrench to tighten the nut securely to prevent gas leaks.
5. Connect the **gas line** to the pressure inlet nipple on the D-coupler and secure it with a clamp. Insert the D-coupler mechanism into the top of the keg and lock it into the lugs with a one-quarter turn clockwise (See Figure 2 & Figure 3).
6. Open the gas tank valves fully to check for leaks by turning the knob counterclockwise.
7. Set the output pressure by adjusting screw on the regulator. Set the **CO<sub>2</sub> output pressure** between **6-12 psi** using the pressure adjusting screw on the regulator.

**Note:** Higher CO<sub>2</sub> pressure will result in more foam, adjust accordingly to achieve the desired pour characteristics.

8. Lock the regulator setting by tightening the locknut on the pressure screw.

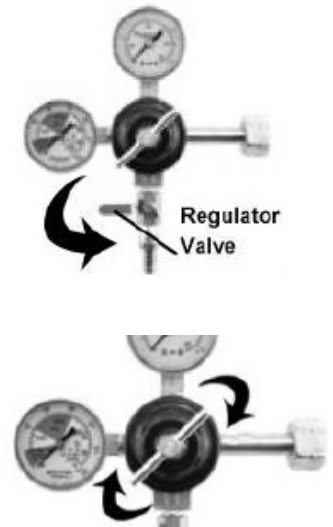

### Attaching the D-Coupler to the Beer Keg:

1. Attach the D-couplers to its respective keg pull the handle out and down until it clicks securely. There will be an audible click, indicating that the gas and keg have been opened and is successfully tapped. (See Figure 4)
2. Position the shut-off lever on the gas line in the downward position to allow the gas to flow. (See image on top right)

**HANDLE CAREFULLY.** Do not jostle or bang keg on the gas canister.

**Note:** The left regulator gauge indicates total tank press.

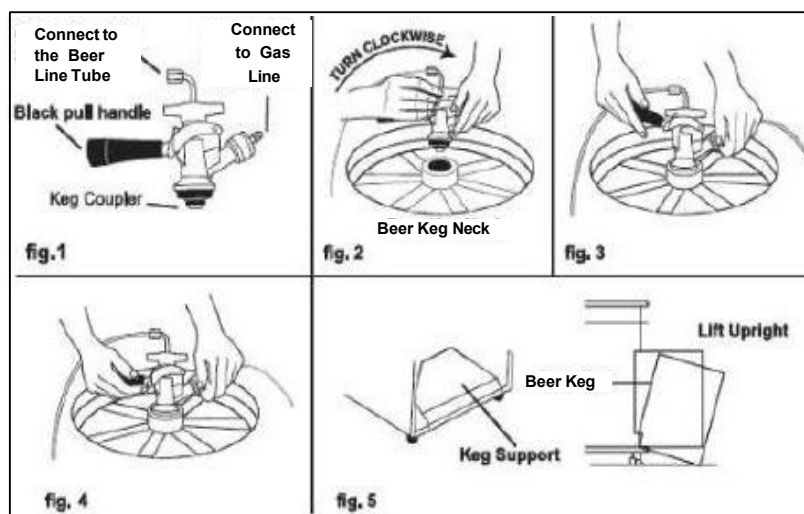

## Installing the N<sub>2</sub> Regulator to the N<sub>2</sub> Tank: (for still cocktails)

1. Ensure the tower dispenser is closed.
2. Ensure the N<sub>2</sub> tank is full. (All gas tanks are shipped empty.)
3. Screw the **N<sub>2</sub> regulator** on to the **N<sub>2</sub> tank valve**. Use an adjustable wrench to tighten the nut securely to prevent gas leaks.
4. Connect the **N<sub>2</sub> gas line** by firmly pressing the **ball lock fitting** onto the keg's **gas inlet** until it clicks into place.
5. Connect the **cocktail line** from the tower to the keg by firmly pressing the ball lock fitting onto the keg's **liquid outlet** until it clicks into place.
6. Open the gas tank valves fully to check for leaks by turning the knob counterclockwise.
7. For non-carbonated cocktails, set the N<sub>2</sub> output pressure between **5 and 10 psi**.
8. Lock the regulator setting by tightening the locknut on the pressure screw.

**Note:** Agitate the keg before serving to keep the cocktail from separating.

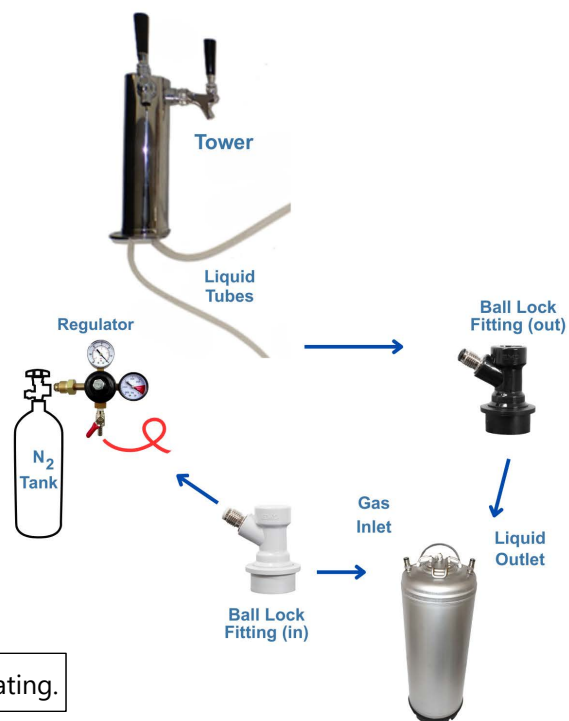

## Placing the Keg and Final Setup

1. Lift the keg(s) by the handles and gently place them inside the unit.
2. Arrange the tubing neatly behind the kegs to ensure the door can close properly.
3. Screw the handle(s) onto the tower tap(s).

If you need help with your installation call our Customer Service facility at **800-932-4267 (Ext. 513)** between 9:00 AM and 5:00 PM ET or visit our website [summitappliance.com/support](http://summitappliance.com/support) at any time. We will do our best to answer your questions.

To order replacement parts, visit our website: [summitapplianceparts.com](http://summitapplianceparts.com)

Summit Appliance Division · Felix Storch, Inc. · [www.summitappliance.com](http://www.summitappliance.com) · 718-893-3900 · [info@summitappliance.com](mailto:info@summitappliance.com)