

ACR1321WNSF456



64.88" x 23.38" x 28.13" (H x W x D)

Upright healthcare all-refrigerator certified to NSF/ANSI 456 with self-closing solid door, front lock, digital controls, and NIST-calibrated temperature readout

Highlights:

- Certified to NSF/ANSI 456 Vaccine Storage Standard
- Specially designed to meet current CDC/VFC vaccine refrigeration guidelines for convenient storage in pharmacies, medical offices, and other healthcare facilities
- Designed and constructed for reliable cold storage in healthcare facilities

Product Features:

EQTemp Healthcare Refrigerator	All-refrigerator designed to operate between 2 and 8°C for a variety of storage application in medical offices and other healthcare facilities
Certified to NSF/ANSI 456 Vaccine Storage Standard	Tested to comply with the latest standards
Certificate of calibration included	The temperature monitoring device (TMD) is calibrated to NIST standards in our ISO/IEC 17025:2017 certified calibration laboratory and ships with a 2-year certificate of calibration for your records
Large capacity	Full 12.71 cu.ft. capacity inside conveniently slim footprint
High/low temperature alarm	Audible alarm sounds if the interior temperature rises or falls out of set range
External temperature readout	Includes continuous display of the current interior and high/low temperature, and can be switched from Celsius to Fahrenheit at the touch of a button
Temperature Range: 2° to 8°C	Preset to 5°C as recommended for many storage applications
Fully finished white cabinet	Allows the unit to be used freestanding
Magnetic door gasket	Quality door gaskets ensure a tight seal for energy savings and improved performance

ACR1321WNSF456 Specifications:

Overview	
Height of Cabinet	64.88" (165 cm)
Width	23.38" (59 cm)
Width with Door Open	23.63" (60 cm)
Depth	28.13" (71 cm)
Depth with door at 90°	50.13" (127 cm)
Capacity	12.71 cu.ft. (360 L)
Defrost Type	Automatic
Door	White
Cabinet	White
US Electrical Safety	ETL
Canadian Electrical Safety	ETL-C
Sanitation	ETL-S to NSF 456
Amps	2.0
Voltage/Frequency	115 V AC/60 Hz
Weight	130.0 lbs. (59 kg)
Parts & Labor Warranty	1 Year
Compressor Warranty	5 Years
UPC	761101083100
Refrigerator Features	
Door Swing	RHD
Reversible	Factory Reversible
Shelf Type	Wire
Shelf Qty	5
Thermostat Type	Digital
Fan Type	Interior
Refrigerant Type	R600a
Refrigerant Amount	2.0oz.
High Side PSI	1.45
Low Side PSI	0.85
Level Legs Qty	2
Temperature Range	2° to 8°C
Sound Level	37.6 dB
Dimensions	
Interior Height	56.5" (144 cm)
Interior Width	20.0" (51 cm)
Interior Depth	21.5" (55 cm)
Compressor Step Height	9.0" (23 cm)

Compressor Step Width	20.0" (51 cm)
Compressor Step Depth	8.0" (20 cm)

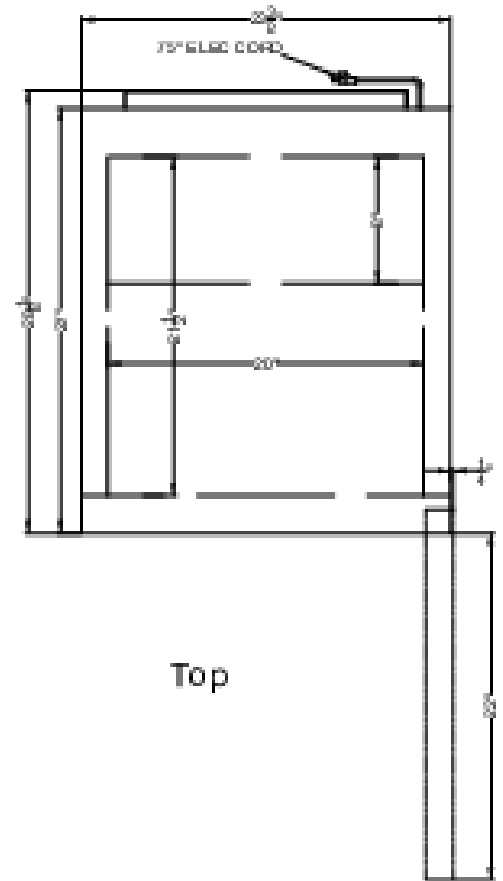

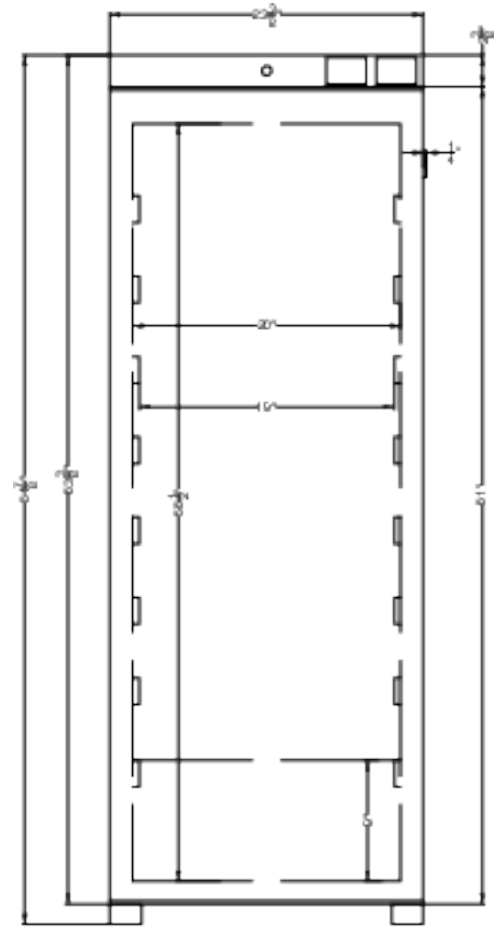

Front