



# FF708BL7SSADA



32.13" x 23.63" x 22.38" (H x W x D)

24" wide commercial 5.1 cu.ft. ADA height all-refrigerator made in Europe with automatic defrost operation, reversible stainless steel door, and deluxe black interior

**Highlights:**

- 32" height allows easy installation under lower ADA compliant counters
- Commercially approved to NSF-7 standards
- Full 5.1 cu.ft. capacity inside a convenient 24" footprint

**Product Features:**

24" wide European all-refrigerator	Freezerless refrigerator designed and manufactured in Europe for use in commercial settings
Commercially listed	ETL-S listed to ANSI-NSF Standard 7 for commercial use
ADA compliant design	32" height allows easy installation under lower ADA compliant counters
Large capacity	5.1 cu.ft. interior offers more storage space than units in this size class
Automatic defrost	No-frost operation for minimum user maintenance
Adjustable glass shelves	Rearrange your refrigerator space to accommodate all shapes and sizes or remove shelves for a simple clean-up
Bottle shelf included	Removable scalloped steel shelf lets you keep wine and other bottles stored horizontally
Fruit and vegetable crisper	Removable clear crisper drawer offers the ideal conditions for keeping produce at its best
Deep shelf space	Interior accommodates large trays up to 19 1/2" x 15 1/2"



## FF708BL7SSADA Specifications:

### Overview

Nominal Height	32.0" (81 cm)
Height of Cabinet	32.0" (81 cm)
Height to Hinge Cap	32.13" (82 cm)
Nominal Width	24.0" (61 cm)
Width	23.63" (60 cm)
Nominal Depth	23.0" (58 cm)
Depth	22.38" (57 cm)
Depth with Handle	24.0" (61 cm)
Depth with door at 90°	44.25" (112 cm)
Capacity	5.1 cu.ft. (144 L)
Defrost Type	Automatic
Door	Stainless Steel
Cabinet	Black
US Electrical Safety	ETL
Canadian Electrical Safety	ETL-C
Sanitation	ETL-S
Energy Usage/Year	291.0kWh/year
Amps	0.8
Voltage/Frequency	115 V AC/60 Hz
Weight	100.0 lbs. (45 kg)
Parts & Labor Warranty	1 Year
Compressor Warranty	5 Years
UPC	761101103112

### Refrigerator Features

Door Swing	RHD
Reversible	Yes
Crisper Qty	1
Crisper Finish	Transparent
Crisper Cover	Glass
Shelf Type	Glass and Scalloped
Shelf Qty	3
Adjustable Shelves	Yes
Wine Bottle Shelves	Yes
Thermostat Type	Dial
Refrigerant Type	R600a
Refrigerant Amount	0.64oz.
Level Legs Qty	2

Interior Light	Yes
Temperature Range	36 to 46°F
Sound Level	32.6 dBA
<b>Dimensions</b>	
Interior Height	27.75" (70 cm)
Interior Width	21.0" (53 cm)
Interior Depth	18.0" (46 cm)
Compressor Step Height	5.5" (14 cm)
Compressor Step Width	21.0" (53 cm)
Compressor Step Depth	6.0" (15 cm)

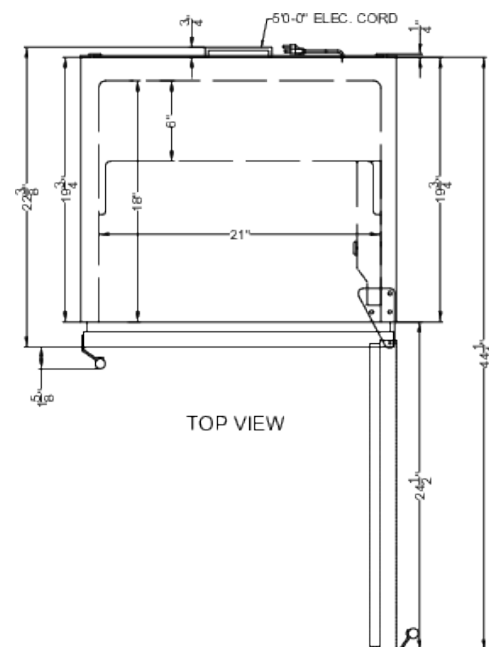

TOP VIEW

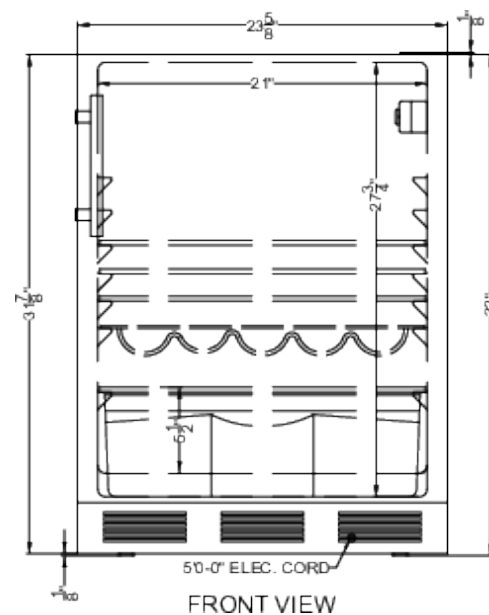

FRONT VIEW