



CREK2W



3" x 15" x 20.88" (H x W x D)

15" wide 230V 2-burner radiant cooktop made in France with white ceramic glass surface and sized for 12 3/8" W x 19 3/8" D cutouts

Highlights:

Uniquely sized at 15" wide to fit common 12 3/8" x 19 3/8" cutouts

Large 7 1/2" 1800W rear burner is ideal for faster heating of large dishes

Smooth EuroKera glass surface offers easy cleanup

Product Features:

15" width	Designed to fit 12 3/8" W x 19 3/8" D cutouts
EuroKera glass surface	Smooth ceramic glass cooking surface in a clean white finish
High output burner	Rear 7 1/2" 1800W burner is ideal for heating larger pots and pans
Standard burner	Front 6" 1200W burner meets most general cooking needs
Push-to-turn controls	Controls require a gentle push to help prevent cooking accidents
Residual heat indicator lights	Indicates when surface is still hot to touch
ADA compliant design	Upfront controls and easy-to-operate knobs offer easier accessibility
220-240V operation	Requires professional hardwired installation



CREK2W Specifications:

Overview	
Height of Cabinet	3.0" (8 cm)
Width	15.0" (38 cm)
Depth	20.88" (53 cm)
Cabinet	White
US Electrical Safety	UL
Canadian Electrical Safety	ULC
Amps	15.0
Voltage/Frequency	230 V AC/60 Hz
Weight	14.0 lbs. (6 kg)
Shipping Weight	15.0 lbs. (7 kg)
Parts & Labor Warranty	1 Year
UPC	761101055541
Electric Cooktop	
Heating Type	Radiant
Surface	Glass
Element Type	Glasstop
Number of Elements	2
controls	Dial
Countertop Cutout Height	3.5" (9 cm)
Countertop Cutout Width	12.38" (31 cm)
Countertop Cutout Depth	19.38" (49 cm)
Power Source	230V
Element #1 Size	6.0" (15 cm)
Element #1 Wattage	1200.0
Element #2 Size	7.5" (19 cm)
Element #2 Wattage	1800.0

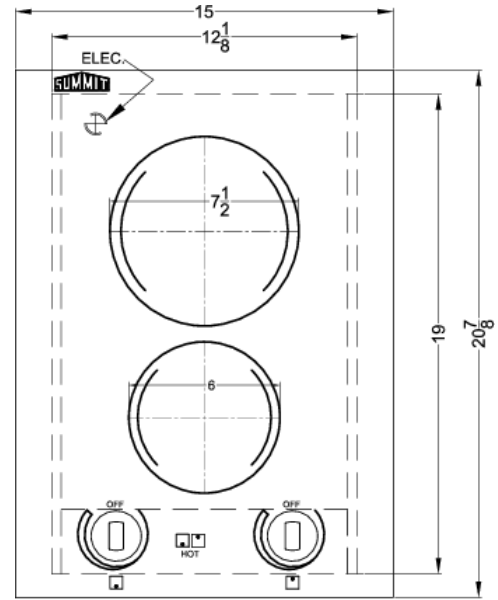

TOP VIEW

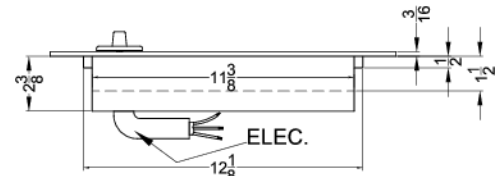

FRONT VIEW